

Tri 3 Media Studio Floor Plan

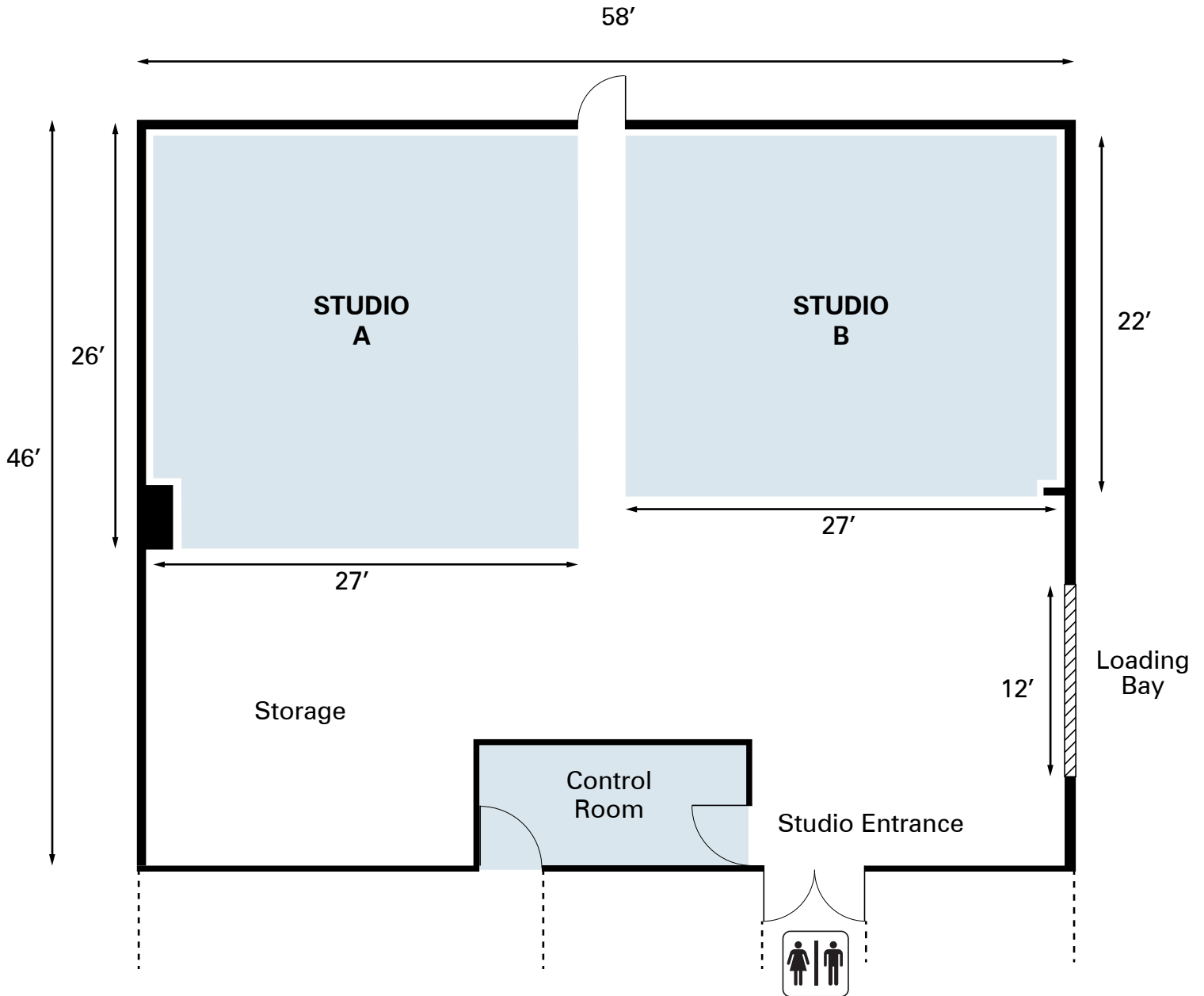

Studio Details

- Overhead studio lighting
- 12' w x 10' h overhead door with drive in loading area with direct access to the studio
- Digitally controlled heating and cooling system
- Stage manager included with rental costs
- Rental Packages for Studio A, Studio B and combining both studios are available

TOTAL: 2700 sq ft

STUDIO A: 700 sq ft

STUDIO B: 600 sq ft

Call: 405-308-4503

209 S Alliance Ct
Oklahoma City, OK 73128
www.tri3media.com